

# City of Surrey



**SURREY**  
CITY OF PARKS

## **"Surrey Tree Protection Bylaw, 2006 No. 16100"**

**A Bylaw to regulate and prohibit the cutting, removal and damage of trees, the setting of fees and issuance of permits for the same and the requirement for replacement trees and of security for their provision and maintenance.**

# INDEX

<b>PART 1</b> .....	<b>1</b>
INTRODUCTORY PROVISIONS.....	1
<b>PART 2</b> .....	<b>8</b>
APPLICATION AND EXEMPTIONS .....	8
<b>PART 3</b> .....	<b>8</b>
PROHIBITIONS.....	8
<b>PART 4</b> .....	<b>9</b>
OFFENCES .....	9
<b>PART 5</b> .....	<b>9</b>
PENALTIES.....	9
<b>PART 6</b> .....	<b>11</b>
SIGNIFICANT TREES.....	11
<b>PART 7</b> .....	<b>11</b>
TREE CUTTING PERMITS.....	11
<b>PART 8</b> .....	<b>14</b>
PERMIT FEES .....	14
<b>PART 8A</b> .....	<b>17</b>
SECURITIES.....	17
<b>PART 9</b> .....	<b>20</b>
REPLACEMENT TREES.....	20
<b>PART 10</b> .....	<b>23</b>
TREE PROTECTION.....	23
<b>PART 11</b> .....	<b>24</b>
INSPECTION AND ASSESSMENT.....	24
<b>PART 12</b> .....	<b>24</b>
GENERAL PROVISIONS.....	24
<b>SCHEDULE "A" DELETED BY BYLAW NO. 20251.</b> .....	<b>26</b>
<b>SCHEDULE "B" SIGNIFICANT TREES</b> .....	<b>27</b>
<b>SCHEDULE "B<sub>1</sub>" SEMIAHMOO TRAIL</b> .....	<b>39</b>
<b>SCHEDULE "C"</b> .....	<b>41</b>



CITY OF SURREY

BYLAW NO. 16100

A Bylaw to regulate and prohibit the cutting, removal and damage of trees, the setting of fees and issuance of permits and the requirement for replacement trees and of security for their provision and maintenance.

.....

As amended by By-law No: 16532, 01/14/08; 16586 03/10/08; 16859, 01/19/09; 16894, 04/20/09; 17047, 11/30/09; 17082, 12/14/09; 17327, 01/10/11; 17371, 03/14/11; 17480, 10/03/11; 17569, 02/06/12; 17635, 05/07/12; 17810, 12/10/12; 17845, 12/17/12; 18138, 01/13/14; 18360, 01/12/15; 18592, 12/14/15; 18659, 03/07/16; 18710, 07/11/16; 18984, 12/19/16; 19430, 12/18/17; 19720, 12/19/18; 19986, 12/16/19; 20223, 12/21/20; 20251, 01/11/21; 20509, 12/24/21; 20876, 04/17/23

THIS IS A CONSOLIDATED BY-LAW PREPARED BY THE CITY OF SURREY FOR CONVENIENCE ONLY. THE CITY DOES NOT WARRANT THAT THE INFORMATION CONTAINED IN THIS CONSOLIDATION IS CURRENT. IT IS THE RESPONSIBILITY OF THE PERSON USING THIS CONSOLIDATION TO ENSURE THAT IT ACCURATELY REFLECTS CURRENT BY-LAW PROVISIONS.

- (a) WHEREAS pursuant to Sections 8(3)(c) and 50 to 52 of the *Community Charter*, S.B.C. 2003, c. 26, a city may, by bylaw, exercise certain powers to preserve and protect trees within the city, regulate the cutting and removal of trees and require their replacement;
- (b) AND WHEREAS Council considers it is in the public interest to provide for the protection and preservation of trees, the regulation of their cutting and removal and their replacement;

Under its statutory powers, including Sections 8(3)(c) and 50 to 52 of the *Community Charter*, S.B.C. 2003, c. 26, the Council of the City of Surrey, in open meeting assembled, enacts the following provisions:

**Part 1**  
**Introductory Provisions**

**Title**

1. This Bylaw may be cited as "Surrey Tree Protection Bylaw, 2006, No. 16100".

## Definitions

2. In this Bylaw,

### **"agricultural use"**

means the use of land for the growing of crops or the raising of livestock as permitted under the Zoning Bylaw.

### **"arborist"**

means an arborist who is both:

- (a) certified as an arborist by the International Society of Arboriculture; and
- (b) is qualified as a tree risk assessor by the International Society of Arboriculture.

### **"arborist report"**

means a technical report prepared by an arborist which may include all or some of the following:

- (a) information relevant to the purpose for which the report is to be submitted to the City including, but not limited to, surveyed location, species, size and condition of the subject tree or trees;
- (b) the reasons for any proposed removal of a tree or trees;
- (c) description of the recommended tree protection and mitigation measures; and
- (d) a tree replacement strategy.

and the General Manager will specify in each instance which of the items listed above are required.

### **"caliper"**

means the diameter of a tree at 15 centimetres [6 inches] above the natural grade of the ground, measured from the base of the tree.

### **"City"**

means the City of Surrey.

**"City Landscape Architect"**

means a person employed by the City and designated by the General Manager as the City's landscape architect.

**"conifer"**

means a cone bearing tree or other plant that has its seeds in a cone structure.

**"Council"**

means the municipal Council of the City of Surrey.

**"cut"**

means to cut down a tree and shall include to pull up, push or pull over or otherwise fall a tree. **"Cutting"** shall have the corresponding meaning.

**"damage"**

means any action which will likely cause a tree to die or to decline, including, but not limited to, ringing, poisoning, burning, topping, root compaction, root cutting, excessive pruning, excessive crown lifting, or pruning in a manner not in accordance with "Best Management Practices, Tree Pruning (Revised 2008)". Topping will not fall within this definition of **"damage"** if evidence satisfactory to the General Manager is provided to the City to establish that the tree in question has been previously topped. **"Damaged"** and **"damaging"** shall have the corresponding meaning.

**"D.B.H."**

means the diameter of a tree at breast height or 1.4 metres [4.6 feet] above the highest point of the natural grade of the ground measured from the base of a tree. For multi-stemmed trees, the three (3) largest stems shall be measured 1.4 metres [4.6 feet] above the highest point of the natural grade and the D.B.H. of the tree shall equal the cumulative total of the D.B.H. of the three (3) largest stems.

**"deciduous"**

means a tree or plant that sheds most or all of its foliage annually.

**"drip line"**

means a horizontal line on the ground encircling a tree corresponding to the furthest extension of the branches of a tree.

**"engineer"**

means a person registered or licensed as a professional engineer pursuant to the provisions of the *Engineers and Geoscientists Act*, R.S.B.C. 1996, c. 116, as amended.

**"Environmental Technician"**

means a person employed by the City and designated by the General Manager as a City environmental technician.

**"General Manager"**

means the person appointed by Council as the General Manager of Planning and Development or the duly authorized representative.

**"landscape architect"**

means a landscape architect registered with the British Columbia Society of Landscape Architects.

**"letter of acceptance"**

means a letter signed by the General Manager, Engineering when the following requirements have been met:

- (a) the engineer for the project on behalf of the owner has requested in writing the letter of acceptance;
- (b) the maintenance period or any extension thereof as set out in the applicable servicing agreement has expired with no identified damage, defect, deficiency or holdback that needs to be dealt with by the owner; and
- (c) the owner has completed all of the terms and conditions in the applicable servicing agreement, including without limitation, the registration in the Land Title Office of all statutory right of ways, easements, restrictive covenants, subdivision plan or Land Title Act section 107 road dedication plan.

**"lot"**

means land designated as a separate and distinct parcel on a legally recorded subdivision plan or description filed in the records of the Land Title Office.

**"natural causes"**

means death or decline of a tree as a result of natural diseases, pests, climactic conditions, inherent structural defects, or senescence.

**"owner"**

means the registered owner in fee simple of a lot upon which a tree is located.

**"protected tree"**

means:

- (a) any tree, including multi-stemmed trees, within the City, regardless of species, having a D.B.H. of 30 centimetres [11.8 inches] or more or, where measurement of the D.B.H. is impossible or impractical, any tree with a stump having a diameter of 30 centimetres [11.8 inches] or more, measured at the natural grade of the ground;
- (b) a replacement tree;
- (c) a tree planted or retained as a requirement of a subdivision application, development permit, development variance permit, building permit or demolition permit;
- (d) a tree located in a riparian area;
- (e) a specimen quality tree;
- (f) a significant tree;
- (g) a tree with evidence of nesting or use by:
  - (i) raptors as defined in the *Wildlife Act*, R.S.B.C. 1996, c. 488,
  - (ii) osprey, or
  - (iii) a heron colony;
- (h) the following tree species where the tree is 3 metres [118.1 inches] or taller, if coniferous, or a tree having a 5 centimetres [1.9 inches] or greater caliper, if deciduous:
  - (i) *Arbutus* (*Arbutus menziesii*),
  - (ii) Garry Oak (*Quercus garryana*),
  - (iii) Coast Redwood (*Sequoia sempervirens*),
  - (iv) Dawn Redwood (*Metasequoia glyptostroboides*),
  - (v) Giant Redwood (*Sequoiadendron giganteum*),
  - (vi) Maidenhair Tree (*Ginkgo biloba*); and
- (i) any tree located on City property.

**"replacement tree"**

means a tree required to be planted to replace a tree cut, removed or damaged in accordance with this Bylaw.



**"remove"**

means to cut a tree and to remove it from the lot where it exists. **"Removed"**, **"removal"** and **"removing"** shall have the corresponding meaning.

**"retained tree"**

means a tree that has not been permitted for removal. **"Tree to be retained"** shall have the corresponding meaning.

**"riparian area"**

means the horizontal area within a lot, that is calculated by measuring the distance perpendicularly, from the top of bank in the direction away from the stream, where land disturbance of any kind is prohibited by the *Riparian Areas Protection Regulation*, B.C. Reg. 178/2019.

**"significant tree"**

means a tree listed in SCHEDULE "B" and SCHEDULE "B1".

**"sound arboricultural practice"**

means tree planting, pruning and maintenance practices endorsed by the International Society of Arboriculture.

**"specimen quality tree"**

means a tree of any size which an arborist, a landscape architect, or the General Manager deems to be of exceptional value because of its species, condition, form, age or size but which has not been designated by Council to be a significant tree.

**"stream"**

means any of the following, in accordance with the *Water Sustainability Act*, S.B.C. 2014, c. 15, as amended, and the *Riparian Areas Protection Regulation*, B.C. Reg. 178/2019, as amended, that provides fish habitat:

- (a) a watercourse, whether it usually contains water or not;
- (b) a pond, lake, river, creek, brook, ravine, swamp, gulch or natural or channelized stream; or
- (c) a ditch, spring or wetland, that is connected by surface flow to any items referred to in (a) or (b) above.

**"top of bank"**

means:

- (a) the point closest to the boundary of the active floodplain of a stream where a break in the slope of the land occurs such that the grade beyond the break is flatter than 3:1 at any point for a minimum distance of 15 metres measured perpendicularly from the break; and
- (b) for a floodplain area not contained in a ravine, the edge of the active floodplain of a stream where the slope of the land beyond the edge is flatter than 3:1 at any point for a minimum distance of 15 metres measured perpendicularly from the edge.

**"tree cutting permit"**

means the written authority granted by the General Manager pursuant to this Bylaw for the cutting or removal of a specified tree or trees.

**"tree protection barrier"**

means a barrier constructed around a tree in accordance with Schedule "C" of this Bylaw to protect the tree from damage during construction, development or site disturbance.

**"Trees and Landscape Manager"**

means a person employed by the City and designated by the General Manager to oversee the implementation of this Bylaw.

**"tree protection zone"**

means the area within a tree protection barrier. Where a tree protection barrier has not been erected as required by this Bylaw, the tree protection zone shall be the area within which a tree protection barrier should have been erected in accordance with this Bylaw.

**"tree survey"**

means a survey plan prepared by an engineer or by a surveyor registered as a British Columbia land surveyor, that illustrates the location of trees in relation to the property lines of a lot, along with the size and species of each tree, plus any other information required by the General Manager for the purpose of assessing a tree cutting permit application.

## **"Zoning Bylaw"**

means Surrey Zoning Bylaw, 1993, No. 12000, as may be amended or replaced from time to time.

### **Part 2 Application and Exemptions**

3. This Bylaw applies to protected trees and to no other trees.
4. This Bylaw does not apply to protected trees, that are cut, removed or damaged, pursuant to the *Hydro and Power Authority Act*, R.S.B.C. 1996, c. 212 or the *Oil and Gas Activities Act*, S.B.C. 2008, c. 36.
5. This Bylaw does not apply to trees on City-owned property or highways that are cut or removed by the City or its authorized agents in accordance with approved City operations.
- 5.1 This Bylaw does not apply to trees on property owned by either the Government of Canada, the Province, or Metro Vancouver that are cut or removed by that entity or its authorized agents.

### **Part 3 Prohibitions**

6. No person shall cut, remove or damage any protected tree or cause, suffer or permit any such tree to be cut, removed or damaged, except where permitted by and in accordance with the terms of this Bylaw.
7. In the event that a protected tree is in imminent danger of falling and injuring persons or property due to natural causes, and it is not possible to obtain a tree cutting permit prior to the tree falling, the owner may cut the tree or have it cut, but shall report the cutting of the tree to the General Manager within the next business day. The owner shall not remove the tree from the lot until the City has visited the lot and confirmed that the tree was in imminent danger of falling and injuring persons or property. If the City determines that the tree was not in imminent danger, or was in imminent danger, but due to reasons other than natural causes, the City may impose a penalty on the owner in accordance with Part 5.
8. No person shall fail to comply with the terms and conditions of a tree cutting permit issued pursuant to this Bylaw.
- 8.1 No person shall provide information in support of a tree cutting permit application, which is false, inaccurate, incomplete or erroneous.
9. For the purposes of this Bylaw, an arborist report will only be accepted by the City within two (2) years of the date of issuance of the arborist report.

**Part 4  
Offences**

10. Every person is guilty of an offence against this Bylaw and is liable to a fine of not less than FIFTY (\$50.00) DOLLARS and not more than TWENTY THOUSAND (\$20,000.00) DOLLARS per offence, who:
- (a) cuts, removes or damages a tree contrary to this Bylaw or contrary to the terms and conditions of a tree cutting permit;
  - (b) violates any of the provisions of this Bylaw or a tree cutting permit;
  - (c) suffers or permits any act or thing to be done in contravention or violation of any provision of this Bylaw or a tree cutting permit; or
  - (d) omits to do or refrains from doing anything required to be done by any of the provisions of this Bylaw or a tree cutting permit.
11. For the purposes of this Bylaw, each tree cut, removed or damaged in violation of this Bylaw and each day that a violation of this Bylaw is caused or permitted to exist by any person, shall constitute a separate offence.

**Part 5  
Penalties**

12. In addition to any prosecution pursuant to Part 4 of this Bylaw, where an owner cuts, removes or damages, or suffers or permits any tree to be cut, removed or damaged, in contravention of this Bylaw, or in excess of any permission, or in violation of any terms and conditions of a tree cutting permit issued pursuant to this Bylaw, the owner shall pay the penalties imposed under this Part 5 and:
- (a) shall plant on the same parcel of land the number, size and species of replacement trees required by this Bylaw, as determined by the General Manager in accordance with this Bylaw; and, in addition,
  - (b) where the tree cut, removed or damaged is identified in a tree preservation plan approved by the City as a tree to be retained or protected, then the General Manager may require the owner to plant the replacement trees at the exact location as the tree that has been cut, removed or damaged and may require that any building or structure shall not be located within the drip line of the replacement trees at full growth.

13. The penalty for cutting, removing or damaging a protected tree, other than a significant tree or a specimen quality tree, is THREE THOUSAND (\$3,000.00) DOLLARS per tree, or the loss of any securities provided to the City to ensure protection and preservation of the tree, whichever amount is greater. The size, number, species and location of replacement trees and amount of securities required to ensure the planting and maintenance of replacement trees, is to be determined by the General Manager, based on the size, condition, species and location of the tree cut, removed or damaged in contravention of this Bylaw.
14. The penalty for cutting, removing or damaging a significant tree is TWENTY THOUSAND (\$20,000.00) DOLLARS per tree. The size, number, species and location of replacement trees, and amount of securities required to ensure the planting and maintenance of replacement trees, is to be determined by the General Manager based on the size, condition, species and location of the tree cut, removed or damaged in contravention of this Bylaw.
15. The penalty for cutting, removing or damaging a specimen quality tree is FIVE THOUSAND (\$5,000.00) DOLLARS per tree, or the loss of any securities provided to the City to ensure protection and preservation of the tree, whichever amount is greater. The size, number, species and location of replacement trees and amount of securities required to ensure the planting and maintenance of replacement trees is to be determined by the General Manager, based on the size, condition, species and location of the tree cut, removed or damaged in contravention of this Bylaw.
16. The size, number, species and location of replacement trees required as a penalty under this Part 5 and the amount of securities required to ensure their planting and maintenance will be determined by the General Manager and is dependent upon the value of the tree removed and conditions of the lot where the replacement trees are to be planted. Where upsized replacement trees are required by this Bylaw, the amount of the securities will reflect the value of the upsized trees and the related planting and maintenance costs.
17. Except as specified in Section 48, if the owner fails or refuses to plant the required number, size and type of replacement trees in the specified locations within four (4) months of receiving written direction from the General Manager to do so, the City may use the security collected to either have the trees planted onto the owner's lot or use the securities to plant trees elsewhere on City-owned property.
18. If an owner fails or refuses to plant the required number, size and type of replacement trees in the specified locations after receiving written direction from the General Manager to do so, the City, by its employees or other persons, at reasonable times and in a reasonable manner, may enter the owner's lot and fulfill the requirement by planting the replacement trees at the expense of the owner.
19. In the event that the owner of the lot described in Section 18 fails to pay the costs of compliance before the 31<sup>st</sup> day of December in the year following the year that the compliance was effected by the City, the costs shall be added to and form part of the taxes payable on the lot as taxes in arrears.

20. Prosecution of a person pursuant to Part 4 of this Bylaw does not exempt the person from the provisions of Part 5 of this Bylaw.

### **Part 6 Significant Trees**

21. The owner of a significant tree shall maintain or cause to maintain the tree in accordance with sound arboricultural practice.
22. No person shall prune the branches or roots of a significant tree without first obtaining a tree cutting permit to do so in accordance with Part 7. There is no fee for such a permit.
23. A significant tree shall not be cut, removed or damaged in any way unless it is first removed from SCHEDULE "B" by an amendment to this Bylaw.
24. The General Manager, with the consent of the owner of the significant tree, may direct that a plaque or marker, that provides information about the significant tree, be placed near the significant tree.

### **Part 7 Tree Cutting Permits**

25. A person wishing to cut or remove a protected tree shall apply to the General Manager for a tree cutting permit to cut or remove the tree. A tree cutting permit application shall be in a form approved by the General Manager. The tree cutting permit shall be in a form approved by the General Manager. The tree cutting permit may determine the number, size, species and location of replacement trees and required security.
26. Notice of the tree cutting permit shall be posted on the lot for which a tree cutting permit has been issued in a location visible to the public, prior to the commencement of any cutting or removal of a protected tree and shall remain posted on the lot until the completion of all work related to the cutting or removal of protected trees on the lot. The notice shall include a copy of the tree cutting permit, identify by species and location the trees which are to be cut or removed and provide a contact number for the permit holder and the City.
27. A tree cutting permit is not required for the pruning of a protected tree, other than a significant tree. Pruning must follow sound arboriculture practice. The pruning and treatment of diseased trees in accordance with sound arboricultural practice, shall be practiced where possible and practical as an alternative to the cutting or removal of a protected tree. The following is not considered sound arboricultural practice:
  - (a) removal of branches in the upper 50% of the total height of the protected tree;
  - (b) the removal of more than twenty-five percent (25%) of the protected tree's total branches or limbs; and
  - (c) the topping of a protected tree, other than topping carried out under an issued tree cutting permit in the circumstances described in Section 27.2.

- 27.1 Despite Section 27(a) and (b), the pruning of a protected tree may be approved if the owner submits an arborist report which certifies that the pruning is necessary and this report is approved by the City Landscape Architect, the Trees and Landscape Manager or an arborist chosen by the City.
- 27.2 A tree cutting permit may be issued for the topping of a protected tree if the tree was topped prior to the year 2006, or if the tree has lost a portion of the stem by natural causes. The owner is required to submit an arborist report which certifies that the pruning is necessary and where this report is approved by the City Landscape Architect, the Trees and Landscape Manager or an arborist chosen by the City. The General Manager may require, as a condition of the tree cutting permit issued under this Section, that all pruning activity be carried out under the on-site supervision of an arborist.
- 27.3 A tree cutting permit will be issued for the pruning of a significant tree where the owner submits an arborist report which certifies that the pruning is necessary and where this report is approved by the City Landscape Architect, the Trees and Landscape Manager or an arborist chosen by the City. The General Manager may require, as a condition of the tree cutting permit issued under this Section, that all pruning activity be carried out under the on-site supervision of an arborist.
28. The fee for the tree cutting permit shall be determined as set out in Part 8 and shall be paid upon application for the permit. No fee is required for a tree cutting permit issued pursuant to Part 7, Section 27.1, 27.2 or 27.3.
29. Subject to Part 7, Section 35, a tree cutting permit to cut or remove a protected tree, other than a significant tree, may be issued by the General Manager only in the following circumstances:
- (a) where an arborist provides an arborist report to the satisfaction of the General Manager that a tree is an unreasonable hazard to the safety of persons or property, or where the applicant has otherwise demonstrated to the satisfaction of the General Manager that the tree is hazardous, dead, damaged, diseased or in decline beyond expectation of recovery;
  - (b) where the General Manager, or his or her duly authorized representative, or an engineer employed by any public utility or an arborist certifies that in his or her opinion a tree is impairing, interfering with, or presents a risk or hazard to the operation of sewers, drains, water lines, septic fields, electrical lines, poles or other similar equipment and appurtenances and that the impairment, interference or risk cannot be reduced or removed in any way other than the removal of the tree;
  - (c) where the tree prevents the owner of the lot on which the tree is located from developing or using a lot in a manner permitted under the Zoning Bylaw, and the development or use cannot be modified to accommodate the tree without causing the owner undue hardship as determined by the General Manager;

- (d) where:
    - (i) the tree is situated within two (2) metres of an existing building foundation wall permitted pursuant to the Zoning By-law, as measured from the outer stem of the tree at 1.4 metres up the stem, to the foundation; or
    - (ii) a building permitted by the Zoning By-law is proposed and the building layout, location, or shape cannot be modified to accommodate the tree without causing the owner undue hardship as determined by the General Manager.
  - (e) where the tree is situated on a lot within the Agricultural Land Reserve, which is zoned to permit agricultural use and the application is accompanied by a sworn declaration of the owner declaring that the tree is to be cut or removed to permit agricultural use, that the agricultural use cannot be located elsewhere on the lot so as to accommodate the tree, and that the owner agrees in writing that no application for subdivision, rezoning, or development of that lot will be accepted by the City for a period of five (5) years commencing on the date of issuance of the tree cutting permit; or
  - (f) where the tree is situated on a lot outside the Agricultural Land Reserve, which is zoned to permit agricultural use and the application is accompanied by an arborist report and by a sworn declaration of the owner declaring that the tree is to be cut or removed to permit agricultural use, that the agricultural use cannot be located elsewhere on that lot so as to accommodate the tree, and where the owner enters into a restrictive covenant registered on the title of the lot documenting that the owner has agreed not to make application for development of the lot for a period of ten (10) years, and that full replacement trees and all other applicable provisions of this Bylaw, as determined by the General Manager, will apply should the development application be considered for the lot within the ten (10) year period.
30. The General Manager may issue a tree cutting permit for the removal of a protected tree other than a significant tree where the owner submits an arborist report which documents that the protected tree, by virtue of its size and species, is inappropriate for its location and the reasons that it is deemed to be inappropriate for its location, all to the satisfaction of the General Manager. The General Manager shall determine the number, size, species and location of replacement trees and required securities.
31. Deleted.
32. The General Manager may, as a condition of any tree cutting permit:
- (a) require that a tree survey, arborist report in accordance with the terms of the tree cutting permit application, or both, accompany the tree cutting permit application;
  - (b) require that preliminary lot grading and servicing plans accompany the tree cutting permit application;



- (c) require that the cutting and removal of trees or specific trees be carried out under the supervision of an arborist;
  - (d) recommend the treatment of diseased trees in accordance with sound arboricultural practice as an alternative to the removal of a protected tree;
  - (e) determine the location, number, species and size of replacement trees required; and
  - (f) require that a replacement tree plan be submitted by an arborist.
33. The General Manager may revoke a tree cutting permit if the terms and conditions of the permit have been breached or the information supplied by the applicant in support of the permit is found by the General Manager to have been inaccurate, incomplete or erroneous.
34. The General Manager may retain the services of an independent arborist to review an arborist report submitted to the City under the provisions of this Bylaw, in support of an application for a tree cutting permit, in instances where the completeness or accuracy of the report are brought into question through a field inspection by the City Landscape Architect, Trees and Landscape Manager or the Environmental Technician. Where the original arborist report submitted to the City is shown to be incomplete or inaccurate, the cost of the independent arborist report shall be paid by the owner and collected by the City, prior to the adoption of the related rezoning or the subdivision approval or the issuance of the related tree cutting permit, whichever comes first.
35. The General Manager may refuse to grant a tree cutting permit for trees located within a riparian area.

## **Part 8 Permit Fees**

### **36. Existing Lots Where No Subdivision is Proposed**

On existing lots zoned for residential use where no subdivision is proposed, as well as on the lots zoned for commercial, industrial, or institutional use where neither subdivision consolidation, nor any development requiring a development permit or development variance permit is proposed, the fee for tree cutting permit shall be a NINETY-NINE (\$99.00) DOLLARS base fee plus THIRTY-EIGHT (\$38.00) DOLLARS for every protected tree removed.

37. **Proposed Subdivisions for Single Family Residential Lots**

The following table shall be used to calculate the fee for a tree cutting permit for proposed subdivisions involving single family residential lots:

Zone and Lot Size	Fees
RF-12, and RF-G, RF-9, RF-12C, RF-13, RF-10, RF-10S and RF-9C Lots smaller than 340 m <sup>2</sup>	\$138.00 per proposed Lot
RF, RF-G Lots greater than or equal to 340 m <sup>2</sup> , RF-SS, R-F(R), R-F(F), R- F(C)	\$165.00 per proposed Lot
RH, RH-G, R-H(G), RQ	\$199.00 per proposed Lot
RA, RA-G, RC	\$628.00 per proposed Lot

All fees are subject to applicable taxes.

38. **Proposed Multi-Family Residential Lots, Commercial, Industrial and Institutional Lots (Other than those described in Part 8, Section 36)**

The following table shall be used to calculate the fee for a tree cutting permit for sites proposed for multi-family residential, commercial, industrial and institutional use:

Zone Designation	Fees
RM-D, RM-M, RM-10, RM-15 RM-30, RM-45 RM-70, RM-135 RMC-135, RMC-150, RMS-1, RMS-1A, RMS-2, R-F(D), R-F(m), R-T(1), RM-1, RM-2, RM-3, RM-4, P-P, C-4, C-5, C-8, C8A, C-8B, C-15, C-35, CHI, CG-1, CG- 2, CTA, CCR, CPR, CPG-, CPM, C-L, C-R(1), CR(2), C-R(3), C-S, C-C, C-H, I-S, C-G(1) C-G(2), C-T(1), C-T(2), P-P(1), P-R, P-D, IB, IL, IH, IS, IA, CD, I-1, I-P(2), I-G, I-T, I-W, I-H, I-W, I-L(S), I-A PC, PA-1, PA-2, PI	\$628.00 per acre

All fees are subject to applicable taxes.

39. **Agricultural Lots**

The following table shall be used to calculate the fee for a tree cutting permit for sites zoned or proposed for agricultural use:

Zone Designation	Fees
A-1, A-2, A-3	\$513.00 per acre
A-1, A-2, A-3 within the ALR	\$513.00 per acre

All fees are subject to applicable taxes.

For the purposes of Part 8, Section 39, the number of acres is based on the area to be cleared and not on the area of the entire lot.

40. Where a tree cutting permit must be amended to show a change in the number or location of trees to be retained or removed after the tree cutting permit has been issued, the permit holder will be required to pay a non-refundable permit amendment fee in the amount of ONE HUNDRED and THREE (\$103.00) DOLLARS plus applicable taxes.
41. For the purposes of determining the fees under Part 8, any lot against which a land use contract has been registered shall be deemed to have the zone underlying the applicable land use contract and lots zoned pursuant to Surrey Zoning Bylaw, 1979, No. 5942, as amended, shall be deemed to have the zoning which corresponds to the zone name in Zoning Bylaw, 1979, No. 5942, as amended.

## **Part 8A Securities**

### **General**

42. Where replacement trees or retention of existing trees are required as a condition of a tree cutting permit or as part of a penalty for cutting, removing or damaging protected trees without a tree cutting permit or cutting, removing or damaging trees in excess of the number allowed by the tree cutting permit, the owner or person responsible for the cutting, removal or damage shall provide to the City a security deposit in cash or letter of credit in the amount specified on the tree cutting permit or a penalty notice, for the period and on the terms specified in Part 8A of this Bylaw. No interest shall be paid by the City on security deposits.
43. Any letter of credit required to be provided under this Bylaw shall be a clean, unconditional and irrevocable letter of credit drawn from a Canadian financial institution acceptable to the City and in a form acceptable to the City. If, for any reason, the irrevocable letter of credit ceases to be effective security or becomes unenforceable so as to remove or reduce its purpose as full security for the due and proper performance of the requirements of this Bylaw, the owner shall replace it with a further letter of credit acceptable to the City within twenty-one (21) days prior to the expiry of the letter of credit then held by the City. If the owner fails to do so, the City will draw down on the current letter of credit without notice or restriction and hold the monies in lieu thereof.
44. If at any time an owner fails to comply with the provisions of this Bylaw relating to requirements for retention of existing trees or replacement trees and their maintenance, the City may by its employees or others under its direction enter upon the lands that are the subject of the requirements to plant replacement trees or maintain protected trees and for such purposes may draw upon the securities provided and expend the funds to cover all costs and expenses of so doing. Alternatively, the City may use the securities to plant trees elsewhere on any City-owned property.

## Replacement Trees

45. The amount of the security for the provision, installation and maintenance of replacement trees, as may be required by this Bylaw, shall be as follows:
- (a) FIVE HUNDRED AND FIFTY (\$550.00) DOLLARS, plus applicable taxes per replacement tree where the replacement tree required is a five (5) centimetre caliper deciduous tree or a three (3) metre tall conifer;
  - (b) ONE THOUSAND ONE HUNDRED (\$1,100.00) DOLLARS, plus applicable taxes per replacement tree where the replacement tree required is an eight (8) centimetre caliper deciduous tree or a four (4) metre tall conifer;
  - (c) as specified by the General Manager when the replacement tree is other than the sizes listed in 45(a) or 45(b); and
  - (d) where the replacement trees are part of the overall landscaping required under a development permit, development variance permit or subdivision, the security is to be in the amount specified in the approved landscape cost estimate associated with the development permit, development variance permit or subdivision.

## Retained Trees

46. The amount of security for the trees proposed to be retained as a requirement of a subdivision application, development permit, development variance permit, building permit or demolition permit shall be as follows:
- (a) TEN THOUSAND (\$10,000.00) DOLLARS per significant tree;
  - (b) FIVE THOUSAND (\$5,000.00) DOLLARS per specimen quality tree;
  - (c) THREE THOUSAND (\$3,000.00) DOLLARS per protected tree other than 46(a) and 46(b) above;
  - (d) The total amount of security required under this Section may not exceed FIFTEEN THOUSAND (\$15,000.00) DOLLARS for a single family dwelling on an existing lot of record; and
  - (e) The total amount of security deposited under this Section may not exceed ONE HUNDRED AND FIFTY THOUSAND (\$150,000.00) DOLLARS for each subdivision, development permit, development variance permit or re-zoning application.

### **Release of Securities for Retained Trees**

- 46.1 The security provided to the City under Section 46 will be held by the City until an Environmental Technician determines that they have not been damaged during construction.
- 46.2 The security provided to the City under Section 46 for retained trees will be eligible for an inspection by an Environmental Technician if one of the following conditions are met:
  - (a) twelve (12) months after a Letter of Acceptance is issued by the City;
  - (b) two (2) years after Building Final has been issued; or
  - (c) at the discretion of the General Manager.

### **Release of Securities for Replacement Trees and Landscaping**

- 47. The amount of security held by the City under Section 45 shall be released in stages as provided in Sections 48 and 49. It will be a condition of the release of any security provided under this Bylaw, that the General Manager be satisfied that the owner has complied with the tree replacement and maintenance requirements of this Bylaw and the tree cutting permit.
- 48. Subject to Section 47, a security deposit collected to cover the cost and maintenance of a replacement tree, shall be reduced as follows:
  - (a) by fifty (50%) percent of the original amount after the planting of replacement trees has been approved by the City in accordance with the inspection requirements as set out in Part 11; and
  - (b) by the balance of the deposit after one year from the date of the first reduction provided that the condition of the replacement trees has been approved by the City in accordance with the inspection requirements as set out in Part 11.
- 49. Subject to Section 47 a security deposit collected to cover the total costs of the required landscaping, including replacement trees, shall be reduced as follows:
  - (a) by ninety (90%) percent of the original amount after the landscaping is completed and approved by the City in accordance with the inspection requirements set out in Part 11; and
  - (b) by the balance of the deposit after three (3) months from the date of the first reduction provided that the landscaping is approved by the City in accordance with the inspection requirements set out in Part 11.

49.1 If the time in Section 49(b) has passed without completion of the required work, a strata corporation that owns the lands upon which the work is to be done may request that the balance of the deposit be paid to the strata corporation. Upon receipt of such request the City will provide written notice to the person who paid the deposit at the last contact address in the City's files. The person who paid the deposit may then:

- (a) carry out the required work; or
- (b) agree in writing to allow the City to pay the deposit to the strata corporation,

and if the person does not carry out the work or respond within the time specified in the notice, the City may pay all or part of the deposit to the strata corporation upon completion by the strata corporation of the required work. The General Manager may require copies of invoices paid by the strata corporation, or such other proof as may be determined necessary by the General Manager, prior to payment of all or part of the deposit to the strata corporation.

### **Forfeit of Securities**

49.2 If replacement trees are not planted as required under a tree cutting permit issued independently of a building permit, development permit, subdivision or rezoning, the replacement tree securities will be forfeited to the City two (2) years from the date of issuance of the tree cutting permit.

49.3 If replacement trees are not planted as required under a tree cutting permit issued for a building permit, development permit, subdivision or rezoning, the replacement tree securities will be forfeited to the City two (2) years from the date the building receives final approval or a letter of acceptance has been issued for the project, whichever is earlier. If the replacement trees are not planted and the building does not receive final approval or a letter or acceptance has not been issued, then the replacement tree securities will be forfeited to the City five (5) years from the date the tree cutting permit was issued.

49.4 If required landscaping, including replacement trees, is not carried out, the securities described in Section 49 will be forfeited to the City ten (10) years from the date the securities were paid to the City.

### **Part 9 Replacement Trees**

50. Replacement trees shall be required in accordance with this Bylaw for each lot from which any protected tree is cut, removed or damaged and must be of a species and size as determined by the General Manager or as specified in the tree cutting permit, at the discretion of the General Manager. Replacement trees required pursuant to Part 5 shall be of a size, species and location as determined by the General Manager.

51. Replacement Trees must meet the plant condition and structure requirements set out in the latest edition of the CNLA/CSLA "Canadian Landscape Standard" and the CNLA "Canadian Nursery Stock Standard" to be considered acceptable by the General Manager.

52. Replacement Trees must be planted and maintained in accordance with the requirements set out in the latest edition of the CNLA/CSLA "Canadian Landscape Standard.
53. Replacement Trees shall be planted, where possible, on the same lot as the trees that are cut or removed from the lot, to the extent that the lot will accommodate such replacement trees in accordance with sound arboricultural practice.
- 53.1 Replacement trees shall not be planted:
- (a) within 1 metre of any property line of a lot;
  - (b) within 3.5 metres of a permitted building or structure's foundation wall;
  - (c) within 1 metre of service lines including but not limited to sanitary, water, electrical, underground services;
  - (d) within 1 metre of any hardscape including but not limited to retaining walls, driveways, patios, walkways;
  - (e) within 3 metres of another tree; or
  - (f) within 3 metres of overhead powerlines.
- 53.2 Replacement trees must be planted in a space that will be appropriate for the mature height and size of the tree species planted. Appropriate tree species may be recommended by an arborist and must be accepted by an Environmental Technician.
54. Where no construction or site disturbance is proposed that would affect the planting of replacement trees, the replacement trees must be planted within ninety (90) days of the date of issuance of the tree cutting permit.
55. Where a replacement tree is to be planted pursuant to Part 5 of this Bylaw, it must be planted within ninety (90) days of written notice being delivered to the owner by the City.
56. Where the planting of replacement trees would hinder proposed construction or where proposed construction would jeopardize the survival of replacement trees, the replacement trees must be planted within ninety (90) days of the final occupancy approval for the last building being constructed that would jeopardize the survival of the tree, but in any case, within three (3) years of the date of the issuance of the tree cutting permit when the date of construction completion is not known, except where an extension of time is granted in writing by the General Manager.
57. The number of replacement trees required under Section 50 shall be two (2) replacement trees for each one (1) protected tree that is cut, removed, or damaged except as follows:
- (a) if the protected tree is a red alder or black cottonwood, and the tree is not located within a riparian area, the number of replacement trees required shall be one (1) tree for each one (1) protected tree that is cut, removed, or damaged;



- (b) if, in the assessment of the General Manager, the lot cannot accommodate two (2) replacement trees for each protected tree that is cut, removed or damaged without compromising sound arboricultural practices, due to the size or other characteristics of the lot, then the number of replacement trees required will be reduced to the number of replacement trees that can be accommodated as determined by the General Manager;
  - (c) if Section 57(a) applies and, in the assessment of the General Manager, the lot cannot accommodate one (1) replacement tree for each protected red alder or black cottonwood tree that is cut, removed or damaged without compromising sound arboricultural practices, due to the size or other characteristics of the lot, then the number of replacement trees required for the red alder and black cottonwood trees will be reduced to the number of replacement trees that can be accommodated as determined by the General Manager; and
  - (d) If the number of replacement trees required is reduced under Section 57(b) or (c), the owner shall be required to pay cash-in-lieu to the City in the amount of FIVE HUNDRED AND FIFTY (\$550.00) DOLLARS plus applicable taxes for each replacement tree that cannot be accommodated.
58. The General Manager may reduce the number of replacement trees required in Section 57 and increase the size of the required replacement trees and increase the amount of securities from FIVE HUNDRED AND FIFTY (\$550.00) DOLLARS plus applicable taxes per tree to ONE THOUSAND ONE HUNDRED (\$1100.00) DOLLARS plus applicable taxes per tree where it is determined by the General Manager that upsizing is required.
59. The cash-in-lieu described in Section 57 shall not exceed FORTY-ONE THOUSAND TWO HUNDRED AND FIFTY (\$41,250.00) DOLLARS, plus applicable taxes per acre of land from which trees are removed.
60. The number of replacement trees to be planted on each lot in single family subdivisions, based on the zoning designation of the lot being created, may not exceed the number as specified below, provided that the requirements of Sections 57, 58, and 59 are met:

<b>Size of Lot Being Created</b>	<b>No. of Replacement Trees Required Per New Lot</b>
Lots smaller than 340 m <sup>2</sup>	0, unless otherwise determined by the General Manager
Lots 341 m <sup>2</sup> to 460 m <sup>2</sup>	2
Lots 461 m <sup>2</sup> to 580 m <sup>2</sup>	3
Lots 581 m <sup>2</sup> to 700 m <sup>2</sup>	4
Lots 701 m <sup>2</sup> to 820 m <sup>2</sup>	5
Lots larger than 821 m <sup>2</sup>	To be determined by the General Manager

61. Where the total number of replacement trees required for the subdivision is less than one-half of the total number of protected trees to be removed from the parent lots that are being subdivided, the General Manager may require that the size of the replacement trees be increased and the amount of securities be increased to reflect the larger size of the replacement trees.
62. Where a tree that is not a protected tree is proposed to be retained within a proposed subdivision, and where the tree is the same size or larger than the size of the required replacement tree, the retained tree may be considered as one (1) of the replacement trees required for that lot, provided that it is growing in a location that does not conflict with proposed buildings, driveways, services or the construction of those buildings, driveways or services. If the number of trees retained on one (1) lot exceeds the number of replacement trees required for that lot, the extra trees may be credited against other lots. However, this transfer of credits from one (1) lot to another will be limited to a maximum of one (1) credit per lot, provided that a minimum of one (1) tree is planted in the front yard of each new lot.

**Part 10**  
**Tree Protection**

63. Where the trunk of any protected tree is within ten (10) metres of any excavation, demolition, construction, or engineering works, or as otherwise required by the General Manager, a tree protection barrier must be installed around the protected tree in accordance with Schedule "C".
64. No demolition permit, building permit or tree cutting permit shall be issued before the tree protection barrier has been installed and approved by either the Environmental Technician or the General Manager or his duly authorized representative, unless otherwise directed by the General Manager.
65. A tree protection barrier must remain in place and in accordance with Schedule "C" until the removal of the tree protection barrier is approved by the General Manager.
66. Site disturbance within the tree protection zone is prohibited including, but not limited to, site grading, deposition or storage of soil or any other any material, disposal of any toxic material, access by any vehicular traffic or heavy equipment, storage of construction equipment, excavation, or use of the area as an amenity space during construction.
67. Any work within a tree protection zone must be approved by the General Manager, prior to its commencement and the General Manager may refuse to allow the work or may specify conditions under which the work is to be undertaken.

**Part 11**  
**Inspection and Assessment**

68. The Environmental Technician, City Landscape Architect, Trees and Landscape Manager, an arborist or similarly qualified expert retained by the General Manager to provide technical advice to the General Manager, or any Bylaw Enforcement Officer of the City is authorized to enter at all reasonable times without the consent of the owner on any lot that is subject to the Bylaw to ascertain whether the regulations, prohibitions and requirements of this Bylaw or any tree cutting permit are being met or to assess or inspect any tree or tree remains on the lot.
69. Where a protected tree has been cut or damaged on a lot in violation of this Bylaw, without a tree cutting permit, or in excess of any permission or in violation of any terms and conditions of a tree cutting permit, the trunks, limbs, roots, and remains of the cut or damaged tree shall not be removed from the lot until an investigation and assessment by the General Manager is completed and the removal is expressly authorized by the General Manager.
70. In accordance with Part 8, Section 47, once all replacement trees required under a tree cutting permit have been planted, or once the landscaping requirements of a development permit or building permit have been substantially completed, the owner may either:
- (a) request that the Environmental Technician conduct a field review to confirm that the replacement trees or landscaping have been provided and installed in accordance with this Bylaw and any related permits, and if a reduction or release of securities is in order; or
  - (b) have a landscape architect submit to the City a sealed BCSLA Schedule C-L along with a field review, provided that the same landscape architect has previously submitted to the City a BCSLA Schedule L for the same project and work.
71. A TWO HUNDRED and TWENTY (\$220.00) DOLLARS plus applicable taxes Site Visit fee will be charged for every field review that has been requested and conducted after the first review for any project, where no reasonable attempt has been made by the owner to correct the deficiency(s) identified during the previous field review. No further field reviews will be conducted until the Site Visit fee has been paid in full.

**Part 12**  
**General Provisions**

72. Deleted.
73. All Schedules referred to herein are attached to and form part of this Bylaw.
74. The provisions of this Bylaw are several and the invalidity of any part of this Bylaw shall not affect the validity of the remainder of this Bylaw.

75. This Bylaw shall come into force on the date of final adoption hereof.

PASSED THREE READINGS on the 11<sup>th</sup> day of September, 2006.

RECONSIDERED AND FINALLY ADOPTED, signed by the Mayor and Clerk and sealed with the Corporate Seal on the 25th day of September, 2006.

\_\_\_\_\_ Mayor

\_\_\_\_\_ Clerk

**SCHEDULE "A"**  
**Deleted by Bylaw No. 20251.**

**SCHEDULE "B"**  
**Significant Trees**

<b>Tree No.</b>	<b>Tree Species</b>	<b>Location</b>	<b>Owner</b>	<b>Heritage Plaque Number (if applicable)</b>
1.	English Oak	King George Blvd - 1984	City of Surrey	
2.	English Oak	King George Blvd - 1985	City of Surrey	
3.	English Oak	King George Blvd - 2009	City of Surrey	
4.	English Oak	King George Blvd - 2015	City of Surrey	
5.	English Oak	King George Blvd - 2023	City of Surrey	
6.	English Oak	King George Blvd - 2050	City of Surrey	
7.	English Oak	King George Blvd - 2078	City of Surrey	
8.	English Oak	King George Blvd - 2120	City of Surrey	
9.	English Oak	King George Blvd - 2121	City of Surrey	
10.	English Oak	King George Blvd - 2130	City of Surrey	
11.	English Oak	King George Blvd - 2140	City of Surrey	
12.	English Oak	King George Blvd - 2150	City of Surrey	
13.	English Oak	King George Blvd - 2155	City of Surrey	
14.	English Oak	King George Blvd - 2195	City of Surrey	
15.	English Oak	King George Blvd - 2227	City of Surrey	
16.	English Oak	King George Blvd - 2511	City of Surrey	
17.	English Oak	King George Blvd - 2525	City of Surrey	
18.	English Oak	King George Blvd - 2567	City of Surrey	
19.	English Oak	King George Blvd - 2601	City of Surrey	
20.	English Oak	King George Blvd - 2619	City of Surrey	
21.	English Oak	King George Blvd - 2620	City of Surrey	
22.	English Oak	King George Blvd - 2646	City of Surrey	
23.	English Oak	King George Blvd - 2812	City of Surrey	
24.	English Oak	King George Blvd - 2825	City of Surrey	
25.	English Oak	King George Blvd - 2845	City of Surrey	
26.	English Oak	King George Blvd - 2855	City of Surrey	
27.	English Oak	King George Blvd - 2875	City of Surrey	
28.	English Oak	King George Blvd - 2885	City of Surrey	
29.	English Oak	King George Blvd - 2925	City of Surrey	
30.	English Oak	King George Blvd - 2952	City of Surrey	
31.	English Oak	King George Blvd - 2958	City of Surrey	
32.	English Oak	King George Blvd - 2962	City of Surrey	
33.	English Oak	King George Blvd - 2970	City of Surrey	
34.	English Oak	King George Blvd - 2986	City of Surrey	
35.	English Oak	King George Blvd - 3061	City of Surrey	
36.	English Oak	King George Blvd - 3155	City of Surrey	
37.	English Oak	King George Blvd - 3189	City of Surrey	
38.	English Oak	King George Blvd - 3237	City of Surrey	
39.	English Oak	King George Blvd - 3247	City of Surrey	
40.	English Oak	King George Blvd - 3269	City of Surrey	
41.	English Oak	King George Blvd - 3329	City of Surrey	

Tree No.	Tree Species	Location	Owner	Heritage Plaque Number (if applicable)
42.	English Oak	King George Blvd - 3331	City of Surrey	
43.	Various	Cloverdale Library 17671 - 56 Avenue	City of Surrey	
44.	Various	St. Helen's Church 10787-128 Street	Synod of the Diocese of New Westminster	
45.	Various	Christ Church and Cemetery 16631 Old McLellan Road	Synod of the Diocese of New Westminster	
46.	Various	Elgin Hall 14250 Crescent Road	City of Surrey	
47.	Various	Elgin Centre 3530-144 Street	City of Surrey	
48.	Various	Pillath Hall/ House 11113-148 Street	City of Surrey	
49.	Various	Crescent Road, which land was designated as a heritage area and is more particularly described in Section 2 of "Surrey Municipal Heritage Site Designation Bylaw, 1983, No. 7716"	City of Surrey	
50.	Various	Steward House/Ward's Marina 13723 Crescent Road	City of Surrey	
51.	Red Cedar Stump	8920 Queen Mary Boulevard	City of Surrey	
52.	Various	Old Anniedale School 9744-176 Street	Surrey School District No. 36	
53.	Royal Oak Tree	16613 Old McLellan Road	City of Surrey	
54.	Douglas Fir	Avenue of Trees 16613 Old McLellan Road	City of Surrey	
55.	Various	5418-184 Street Robert Dougal MacKenzie House	Private	12
56.	English Oak	King George Blvd - 3333	City of Surrey	
57.	English Oak	King George Blvd - 3387	City of Surrey	
58.	English Oak	King George Blvd - 3389	City of Surrey	
59.	English Oak	King George Blvd - 3391	City of Surrey	
60.	English Oak	King George Blvd - 3393	City of Surrey	
61.	English Oak	King George Blvd - 3395	City of Surrey	
68.	English Oak	King George Blvd - 1195	City of Surrey	
69.	English Oak	King George Blvd - 1201	City of Surrey	
70.	English Oak	King George Blvd - 1210	City of Surrey	
71.	English Oak	King George Blvd - 1211	City of Surrey	
72.	English Oak	King George Blvd - 1221	City of Surrey	
73.	English Oak	King George Blvd - 1231	City of Surrey	
74.	English Oak	King George Blvd - 1250	City of Surrey	
75.	English Oak	King George Blvd - 1251	City of Surrey	
76.	English Oak	King George Blvd - 1255	City of Surrey	

Tree No.	Tree Species	Location	Owner	Heritage Plaque Number (if applicable)
77.	English Oak	King George Blvd - 1259	City of Surrey	
78.	English Oak	King George Blvd - 1265	City of Surrey	
79.	English Oak	King George Blvd - 1269	City of Surrey	
80.	English Oak	King George Blvd - 1272	City of Surrey	
81.	English Oak	King George Blvd - 1275	City of Surrey	
82.	English Oak	King George Blvd - 1276	City of Surrey	
83.	English Oak	King George Blvd - 1279	City of Surrey	
84.	English Oak	King George Blvd - 1280	City of Surrey	
85.	English Oak	King George Blvd - 1284	City of Surrey	
86.	English Oak	King George Blvd - 1288	City of Surrey	
87.	English Oak	King George Blvd - 1289	City of Surrey	
88.	English Oak	King George Blvd - 1292	City of Surrey	
89.	English Oak	King George Blvd - 1293	City of Surrey	
90.	English Oak	King George Blvd - 1296	City of Surrey	
91.	English Oak	King George Blvd - 1299	City of Surrey	
92.	English Oak	King George Blvd - 1300	City of Surrey	
93.	Douglas Fir	5804 Kilkee Drive (Kilkee Park)	City of Surrey	2
94.	Butternut/White Walnut	6272-152 Street (Sullivan Park)	City of Surrey	1
95.	Douglas Fir	15100-22 Avenue	City of Surrey	3
96.	Canadian/Japanese Walnut Cross	1660-168 Street (Darts Hill)	City of Surrey	4
98.	Douglas Fir	1990-134 Street	Private	16
99.	Douglas Fir	9016-164 Street	Private	5
100.	Douglas Fir	19587-0 Avenue	Private	6
101.	Weeping Willow	2865 - 164 Street	Private	15
102.	Sitka Spruce	13398-Vine Maple Drive	Private	7
103.	English Oak	9353-160 Street	City of Surrey	8
104.	Scotch Elm	4100 - 152 Street	Private	Group 10
105.	Nordmann Fir	1660-168 Street (Darts Hill)	City of Surrey	Group 1
106.	Spanish Fir	1660-168 Street (Darts Hill)	City of Surrey	Group 1
107.	Incense Cedar (3 Trees)	1660-168 Street (Darts Hill)	City of Surrey	Group 1
108.	Corkscrew Hazel	1660-168 Street (Darts Hill)	City of Surrey	Group 1
109.	Sekkan Sugi Japanese Cedar	1660-168 Street (Darts Hill)	City of Surrey	Group 1
110.	Sweet Chestnut	1660-168 Street (Darts Hill)	City of Surrey	Group 1
111.	White Mulberry	1660-168 Street (Darts Hill)	City of Surrey	Group 1
112.	Bigleaf Magnolia	1660-168 Street (Darts Hill)	City of Surrey	Group 1
113.	Medlar	1660-168 Street (Darts Hill)	City of Surrey	Group 1
114.	Antarctic Beech	1660-168 Street (Darts Hill)	City of Surrey	Group 1
115.	Ironwood	1660-168 Street (Darts Hill)	City of Surrey	Group 1
116.	Empress Tree	1660-168 Street (Darts Hill)	City of Surrey	Group 1



<b>Tree No.</b>	<b>Tree Species</b>	<b>Location</b>	<b>Owner</b>	<b>Heritage Plaque Number (if applicable)</b>
117.	Oriental Spruce	1660-168 Street (Darts Hill)	City of Surrey	Group 1
118.	Chinese Elm	1660-168 Street (Darts Hill)	City of Surrey	Group 1
119.	Variegated Hiba Arborv.	1660-168 Street (Darts Hill)	City of Surrey	Group 1
120.	California Bay Tree	1660-168 Street (Darts Hill)	City of Surrey	Group 1
121.	China Fir	1660-168 Street (Darts Hill)	City of Surrey	Group 1
122.	Weep. Giant Sequoia	1660-168 Street (Darts Hill)	City of Surrey	Group 1
123.	Western Red Cedar	10648-127 Street	City of Surrey	
124.	Douglas Fir	19016- 96 Avenue (St. Oswalds)	City of Surrey	Group 2
125.	Douglas Fir	19016-96 Avenue (St. Oswalds)	City of Surrey	Group 2
126.	Douglas Fir	19016-96 Avenue (St. Oswalds)	City of Surrey	Group 2
127.	Douglas Fir	19016-96 Avenue (St. Oswalds)	City of Surrey	Group 2
128.	English Oak	19016-96 Avenue (St. Oswalds Church)	City of Surrey	31
129.	Western Red Cedar	19587-0 Avenue	Private	9
130.	European Beech	Peace Arch Park	Province of BC	Group 3
131.	Western White Pine	Peace Arch Park	Province of BC	Group 3
134.	Red Japanese Maple	Peace Arch Park	Province of BC	Group 3
135.	Atlas Cedar	Peace Arch Park	Province of BC	Group 3
136.	Crimson King Maple	Peace Arch Park	Province of BC	Group 3
137.	Maidenhair Tree	Peace Arch Park	Province of BC	Group 3
138.	Lawson's Cypress	Peace Arch Park	Province of BC	Group 3
139.	Horse Chestnut (15 Trees)	17857-56 Avenue (Cloverdale Elementary)	Surrey School District No. 36	Group 4
140.	Incense Cedar	17900-20 Avenue (Redwood Park)	City of Surrey	Group 5
141.	Sweet Chestnut	17900-20 Avenue (Redwood Park)	City of Surrey	Group 5
142.	Golden Lawson's Cypress	17900-20 Avenue (Redwood Park)	City of Surrey	Group 5
143.	English Walnut	17900-20 Avenue (Redwood Park)	City of Surrey	Group 5
144.	Dawn Redwood	17900-20 Avenue (Redwood Park)	City of Surrey	Group 5
145.	Red Oak	17900-20 Avenue (Redwood Park)	City of Surrey	Group 5
146.	Giant Sequoia	17900-20 Avenue (Redwood Park)	City of Surrey	Group 5

<b>Tree No.</b>	<b>Tree Species</b>	<b>Location</b>	<b>Owner</b>	<b>Heritage Plaque Number (if applicable)</b>
147.	Hiba Arborvitae (2 trees)	17900-20 Avenue (Redwood Park)	City of Surrey	Group 5
148.	Siberian Elm	17900-20 Avenue (Redwood Park)	City of Surrey	Group 5
149.	Golden Locust	14239 Melrose	Private	
150.	English Oak Grove	140 Street and 96 Avenue (Green Timbers)	City of Surrey	Group 6
151.	Douglas Fir	5480-184A Street	City of Surrey	21
152.	Oriental Plane	4117-152 Street	Private	10
155.	English Oak	16671 Old McLellan Road	City of Surrey	19
156.	Western Red Cedar	168 Street and 50 Avenue (Mound Farm)	City of Surrey	Group 7
157.	Western Red Cedar	168 Street and 50 Avenue (Mound Farm)	City of Surrey	Group 7
158.	Douglas Fir	168 Street and 50 Avenue (Mound Farm)	City of Surrey	Group 7
159.	Douglas Fir	168 Street and 50 Avenue (Mound Farm)	City of Surrey	Group 7
160.	Douglas Fir	168 Street and 50 Avenue (Mound Farm)	City of Surrey	Group 7
161.	Weep. Norway Spruce	561-172 Street (The Glades)	City of Surrey	Group 8
162.	Kobus Magnolia	561-172 Street (The Glades)	City of Surrey	Group 8
163.	Dove Tree	561-172 Street (The Glades)	City of Surrey	Group 8
164.	Dawn Redwood	561-172 Street (The Glades)	City of Surrey	Group 8
166.	California Bay St	561-172 Street (The Glades)	City of Surrey	Group 8
167.	Mirbeck's Oak	561-172 Street (The Glades)	City of Surrey	Group 8
169.	Western Red Cedar	561-172 Street (The Glades)	City of Surrey	Group 8
170.	Various Arboretum	9800-140 Street (Green Timbers)	City of Surrey	Group 9
171.	English Oak	13997-90 Avenue (on 140 Street)	Private	11
172.	Butternut	6091-181A Street	City of Surrey	28
174.	Sitka Spruce	Tynehead Regional Park	GVRD	
175.	Sitka Spruce	Tynehead Regional Park	GVRD	
176.	Common Apple	18029 Highway 10	Private	
177.	Horse Chestnut	18029 Highway 10	Private	
178.	English Walnut	18029 Highway 10	Private	

Tree No.	Tree Species	Location	Owner	Heritage Plaque Number (if applicable)
179.	English Walnut	18029 Highway 10	Private	
180.	Black Walnut	18029 Highway 10	Private	
181.	Black Walnut	18029 Highway 10	Private	
183.	Douglas Fir	18 Avenue and 136 Street (Bell Park)	City of Surrey	Group 11
184.	Douglas Fir	18 Avenue and 136 Street (Bell Park)	City of Surrey	Group 11
185.	Coulter Pine	12649-25 Avenue	Private	
186.	English Oak	13722-56 Avenue	Private	
187.	Douglas Fir	13600-55A Avenue	City of Surrey	29
188.	Tulip Tree	12976-Old Yale Road	City of Surrey	20
189.	English Walnut	19251-76 Avenue	Private	23
190.	Beech	12691-14 Avenue	Private	
191.	Dead Douglas Fir	South Side of Highway #1 East of 176 Street	Province of B.C.	
193.	Douglas Fir	14158 Hyland Road	City of Surrey	24
194.	Bigleaf Maple	19184-16 Avenue	City of Surrey	25
195.	Brewer's Weeping Spruce	12731 Becket Road	Private	26
196.	Purple Beech	13275 Colebrook Road	City of Surrey	Group 12
197.	Purple Beech	13275 Colebrook Road	City of Surrey	Group 12
198.	Purple Beech	13275 Colebrook Road	City of Surrey	Group 12
199.	Weeping Linden	13275 Colebrook Road	City of Surrey	Group 12
200.	English Oak	13275 Colebrook Road	City of Surrey	Group 12
201.	Rock Tree	12237 - 91A Avenue	Private	
202.	All trees on Semiahmoo Trail	Various lots (see Schedule B1 for details)	City of Surrey	
203.	Common Beech	19340-88 Avenue (Port Kells Park)	City of Surrey	Group 14
204.	Common Beech	19340-88 Avenue (Port Kells Park)	City of Surrey	Group 14
205.	English Oak	19340-88 Avenue (Port Kells Park)	City of Surrey	Group 14
206.	English Oak	19340-88 Avenue (Port Kells Park)	City of Surrey	Group 14
207.	English Oak	19340-88 Avenue (Port Kells Park)	City of Surrey	Group 14
208.	English Oak	19340-88 Avenue (Port Kells Park)	City of Surrey	Group 14
209.	English Oak	19340-88 Avenue (Port Kells Park)	City of Surrey	Group 14
210.	Hedge Maple	19340-88 Avenue (Port Kells Park)	City of Surrey	Group 14

<b>Tree No.</b>	<b>Tree Species</b>	<b>Location</b>	<b>Owner</b>	<b>Heritage Plaque Number (if applicable)</b>
211.	English Oak	19340-88 Avenue (Port Kells Park)	City of Surrey	Group 14
212.	English Oak	19340-88 Avenue (Port Kells Park)	City of Surrey	Group 14
213.	Hedge Maple	19340-88 Avenue (Port Kells Park)	City of Surrey	Group 14
214.	English Oak	19340-88 Avenue (Port Kells Park)	City of Surrey	Group 14
215.	Hedge Maple	19340-88 Avenue (Port Kells Park)	City of Surrey	Group 14
216.	English Oak	19340-88 Avenue (Port Kells Park)	City of Surrey	Group 14
217.	Hedge Maple	19340-88 Avenue (Port Kells Park)	City of Surrey	Group 14
218.	English Oak	19340-88 Avenue (Port Kells Park)	City of Surrey	Group 14
219.	English Oak	19340-88 Avenue (Port Kells Park)	City of Surrey	Group 14
220.	Hedge Maple	19340-88 Avenue (Port Kells Park)	City of Surrey	Group 14
221.	Common Beech	19340-88 Avenue (Port Kells Park)	City of Surrey	Group 14
222.	English Oak	19340-88 Avenue (Port Kells Park)	City of Surrey	Group 14
223.	English Oak	19340-88 Avenue (Port Kells Park)	City of Surrey	Group 14
224.	English Oak	19340-88 Avenue (Port Kells Park)	City of Surrey	Group 14
225.	English Oak	19340-88 Avenue (Port Kells Park)	City of Surrey	Group 14
226.	Common Beech	19340-88 Avenue (Port Kells Park)	City of Surrey	Group 14
227.	English Oak	19340-88 Avenue (Port Kells Park)	City of Surrey	Group 14
228.	Common Beech	19340-88 Avenue (Port Kells Park)	City of Surrey	Group 14
229.	English Oak	19340-88 Avenue (Port Kells Park)	City of Surrey	Group 14
230.	English Oak	19340-88 Avenue (Port Kells Park)	City of Surrey	Group 14
231.	Common Beech	19340-88 Avenue (Port Kells Park)	City of Surrey	Group 14
232.	English Oak	19340-88 Avenue (Port Kells Park)	City of Surrey	Group 14

<b>Tree No.</b>	<b>Tree Species</b>	<b>Location</b>	<b>Owner</b>	<b>Heritage Plaque Number (if applicable)</b>
233.	Sitka Spruce	19340-88 Avenue (Port Kells Park)	City of Surrey	Group 14
234.	Sitka Spruce	19340-88 Avenue (Port Kells Park)	City of Surrey	Group 14
235.	Douglas Fir	19340-88 Avenue (Port Kells Park)	City of Surrey	Group 14
236.	Douglas Fir	19340-88 Avenue (Port Kells Park)	City of Surrey	Group 14
237.	Douglas Fir	19340-88 Avenue (Port Kells Park)	City of Surrey	Group 14
238.	Douglas Fir	18918-88 Avenue (Port Kells Community Hall)	City of Surrey	Group 15
239.	Douglas Fir	18918-88 Avenue (Port Kells Community Hall)	City of Surrey	Group 15
240.	Douglas Fir	18918-88 Avenue (Port Kells Community Hall)	City of Surrey	Group 15
241.	Douglas Fir	18918-88 Avenue (Port Kells Community Hall)	City of Surrey	Group 15
242.	Douglas Fir	18918-88 Avenue (Port Kells Community Hall)	City of Surrey	Group 15
243.	Douglas Fir	18809-88 Avenue (Port Kells Library)	City of Surrey	30
244.	Douglas Fir	19076-88 Avenue (Port Kells Elementary School)	Surrey School District No. 36	Group 16
245.	Douglas Fir	19076-88 Avenue (Port Kells Elementary School)	Surrey School District No. 36	Group 16
246.	Douglas Fir	19076-88 Avenue (Port Kells Elementary School)	Surrey School District No. 36	Group 16
247.	Sugar Maple (12 trees)	8261-188 Street	City of Surrey	Group 17
249.	Douglas Fir	8850 Harvie Road	Private	Group 18
250.	Douglas Fir	8850 Harvie Road	Private	Group 18
251.	White Ash	18385 - 80 Avenue	Private	34
252.	English Oak	9012 - 160 Street	City of Surrey	32
253.	Sugar Maples (2 Trees)	8495 - 144 Street	City of Surrey	Group 13
254.	Silver maple	Surrey Nature Centre at Green Timbers	City of Surrey	Group 9
255.	Norway Maple	Surrey Nature Centre at Green Timbers	City of Surrey	Group 9
256.	Hedge Maple	Surrey Nature Centre at Green Timbers	City of Surrey	Group 9
257.	Whitebeam Mountain Ash	Surrey Nature Centre at Green Timbers	City of Surrey	Group 9

<b>Tree No.</b>	<b>Tree Species</b>	<b>Location</b>	<b>Owner</b>	<b>Heritage Plaque Number (if applicable)</b>
258.	Weeping American Elm	Surrey Nature Centre at Green Timbers	City of Surrey	Group 9
259.	Thornless Honeylocust	Surrey Nature Centre at Green Timbers	City of Surrey	Group 9
260.	Sawara False Cypress	Surrey Nature Centre at Green Timbers	City of Surrey	Group 9
261.	European Beech	Surrey Nature Centre at Green Timbers	City of Surrey	Group 9
262.	Weeping cut-leaf Birch	Surrey Nature Centre at Green Timbers	City of Surrey	Group 9
263.	European Mountain Ash	Surrey Nature Centre at Green Timbers	City of Surrey	Group 9
264.	Dawn Redwood	Surrey Nature Centre at Green Timbers	City of Surrey	Group 9
265.	Golden Atlas Cedar	Surrey Nature Centre at Green Timbers	City of Surrey	Group 9
266.	Sawara False Cypress	Surrey Nature Centre at Green Timbers	City of Surrey	Group 9
267.	Weeping White Mulberry	Surrey Nature Centre at Green Timbers	City of Surrey	Group 9
268.	American Elm	Green Timbers Way	Province of BC	Group 9
269.	Northern Red Oak	Green Timbers Way	Province of BC	Group 9
270.	White Hawthorn	Green Timbers Way	Province of BC	Group 9
271.	Common Horse Chestnut	Green Timbers Way	Province of BC	Group 9
272.	Northern Red Oak	Green Timbers Way	Province of BC	Group 9
273.	Black Locust	Green Timbers Way	Province of BC	Group 9
274.	Western Catalpa	Green Timbers Way	Province of BC	Group 9
275.	Red Maple	Green Timbers Way	Province of BC	Group 9
276.	Purple Leaf English Oak	Green Timbers Way	Province of BC	Group 9
277.	Northern Red Oak	Green Timbers Way	Province of BC	Group 9
278.	Northern Red Oak	Green Timbers Way	Province of BC	Group 9
279.	Northern Red Oak	Green Timbers Way	Province of BC	Group 9
280.	Tulip Poplar	Green Timbers Way	Province of BC	Group 9
281.	Norway Maple	Green Timbers Way	Province of BC	Group 9
282.	Black Locust	Green Timbers Way	Province of BC	Group 9
283.	Atlas cedar	Green Timbers Block H	Province of BC	Group 9
284.	Deodar Cedar	Green Timbers Block H	Province of BC	Group 9
285.	Colorado Blue Spruce	Green Timbers Block H	Province of BC	Group 9
286.	Weeping Giant Sequoia	Green Timbers Block H	Province of BC	Group 9

Tree No.	Tree Species	Location	Owner	Heritage Plaque Number (if applicable)
287.	Sugar Maple	Green Timbers RCMP E Division	Federal	Group 9
288.	European Ash	Green Timbers RCMP E Division	Federal	Group 9
289.	Sugar Maple	Green Timbers RCMP E Division	Federal	Group 9
290.	European Ash	Green Timbers RCMP E Division	Federal	Group 9
291.	American elm	Green Timbers RCMP E Division	Federal	Group 9
292.	Red Maple	Green Timbers RCMP E Division	Federal	Group 9
293.	London Plane	Green Timbers RCMP E Division	Federal	Group 9
294.	Sugar Maple	Green Timbers RCMP E Division	Federal	Group 9
295.	Weeping Willow	8375 - 168 Street	City of Surrey	
296.	American Elm	8135 - 132 Street	City of Surrey	
297.	White Spruce	Elgin Heritage Park, 13723 Crescent Rd.	City of Surrey	
298.	Western Red Cedar	Royal Kwantlen Park, 13079 - 104 Avenue	City of Surrey	
299.	Giant Sequoia	Enver Creek Park, 8170 - 146 Street	City of Surrey	
300.	Yellow Buckeye	Sullivan Park, 6272 - 152 Street	City of Surrey	
301.	Giant Sequoia	Larond Park, 1806 - 130 Street	City of Surrey	
302.	Douglas-fir	Cloverdale Athletic Park	City of Surrey	
303.	Lavalle hawthorn	19083-68B Avenue	City of Surrey	
304.	Coskspur Thorn	Green Timbers Nature Centre	City of Surrey	
305.	Dawn Redwood	Hjorth Road Park	City of Surrey	
306.	Giant Sequoia	Unwin Park, 13313 68 Ave	City of Surrey	
307.	Jeffrey pine	Hillcrest- maple leaf day 2008	City of Surrey	
308.	Western Red Cedar	13124 - 14A Avenue	Private	35
309.	English Oak	King George Blvd - 2200	City of Surrey	
310.	English Oak	King George Blvd - 2202	City of Surrey	
311.	English Oak	King George Blvd - 2204	City of Surrey	
312.	English Oak	King George Blvd - 2206	City of Surrey	
313.	English Oak	King George Blvd - 2208	City of Surrey	
314.	English Oak	King George Blvd - 2225	City of Surrey	
315.	English Oak	King George Blvd - 2227	City of Surrey	
316.	English Oak	King George Blvd - 2251	City of Surrey	
317.	English Oak	King George Blvd - 2255	City of Surrey	
318.	English Oak	King George Blvd - 2281	City of Surrey	
319.	English Oak	King George Blvd - 2293	City of Surrey	

<b>Tree No.</b>	<b>Tree Species</b>	<b>Location</b>	<b>Owner</b>	<b>Heritage Plaque Number (if applicable)</b>
320.	English Oak	King George Blvd - 2297	City of Surrey	
321.	English Oak	King George Blvd - 2300	City of Surrey	
322.	English Oak	King George Blvd - 2301	City of Surrey	
323.	English Oak	King George Blvd - 2302	City of Surrey	
324.	English Oak	King George Blvd - 2304	City of Surrey	
325.	English Oak	King George Blvd - 2306	City of Surrey	
326.	English Oak	King George Blvd - 2308	City of Surrey	
327.	English Oak	King George Blvd - 2310	City of Surrey	
328.	English Oak	King George Blvd - 2315	City of Surrey	
329.	English Oak	King George Blvd - 2320	City of Surrey	
330.	English Oak	King George Blvd - 2336	City of Surrey	
331.	English Oak	King George Blvd - 2337	City of Surrey	
332.	English Oak	King George Blvd - 2355	City of Surrey	
333.	English Oak	King George Blvd - 2377	City of Surrey	
334.	English Oak	King George Blvd - 2381	City of Surrey	
335.	English Oak	King George Blvd - 2423	City of Surrey	
336.	English Oak	King George Blvd - 2428	City of Surrey	
337.	English Oak	King George Blvd - 2430	City of Surrey	
338.	English Oak	King George Blvd - 2451	City of Surrey	
339.	English Oak	King George Blvd - 2460	City of Surrey	
340.	English Oak	King George Blvd - 2461	City of Surrey	
341.	English Oak	King George Blvd - 2466	City of Surrey	
342.	English Oak	King George Blvd - 2471	City of Surrey	
343.	English Oak	King George Blvd - 2480	City of Surrey	
344.	English Oak	King George Blvd - 2491	City of Surrey	
345.	English Oak	King George Blvd - 2498	City of Surrey	
346.	English Oak	King George Blvd - 2500	City of Surrey	
347.	English Oak	King George Blvd - 2524	City of Surrey	
348.	English Oak	King George Blvd - 2530	City of Surrey	
349.	English Oak	King George Blvd - 2536	City of Surrey	
350.	English Oak	King George Blvd - 2546	City of Surrey	
351.	English Oak	King George Blvd - 2569	City of Surrey	
352.	English Oak	King George Blvd - 2570	City of Surrey	
353.	English Oak	King George Blvd - 2571	City of Surrey	
354.	English Oak	King George Blvd - 2601	City of Surrey	
355.	English Oak	King George Blvd - 2641	City of Surrey	
356.	English Oak	King George Blvd - 2645	City of Surrey	
357.	English Oak	King George Blvd - 2649	City of Surrey	
358.	English Oak	King George Blvd - 2650	City of Surrey	
359.	English Oak	King George Blvd - 2651	City of Surrey	
360.	English Oak	King George Blvd - 2655	City of Surrey	
361.	English Oak	King George Blvd - 2660	City of Surrey	
362.	English Oak	King George Blvd - 2670	City of Surrey	



<b>Tree No.</b>	<b>Tree Species</b>	<b>Location</b>	<b>Owner</b>	<b>Heritage Plaque Number (if applicable)</b>
363.	English Oak	King George Blvd - 2675	City of Surrey	
364.	English Oak	King George Blvd - 2680	City of Surrey	
365.	English Oak	King George Blvd - 2690	City of Surrey	
366.	English Oak	King George Blvd - 2700	City of Surrey	
367.	English Oak	King George Blvd - 2710	City of Surrey	
368.	English Oak	King George Blvd - 2713	City of Surrey	
369.	English Oak	King George Blvd - 2751	City of Surrey	
370.	English Oak	King George Blvd - 2755	City of Surrey	
371.	English Oak	King George Blvd - 2759	City of Surrey	
372.	English Oak	King George Blvd - 2763	City of Surrey	
373.	English Oak	King George Blvd - 2765	City of Surrey	
374.	English Oak	King George Blvd - 2769	City of Surrey	
375.	English Oak	King George Blvd - 2770	City of Surrey	
376.	English Oak	King George Blvd - 2780	City of Surrey	
377.	English Oak	King George Blvd - 2790	City of Surrey	
378.	English Oak	King George Blvd - 2800	City of Surrey	
379.	Common Horse Chestnut	12645 - 14B Avenue	City of Surrey	
380.	Giant Sequoia	9700 Block - 168 Street	City of Surrey	
381.	Black Walnut	10871 - 139A Street	Private	
382.	Douglas Fir	9631 - 161A Street	Private	

**SCHEDULE "B1"  
Semiahmoo Trail**



# SCHEDULE "B1" Semiahmoo Trail

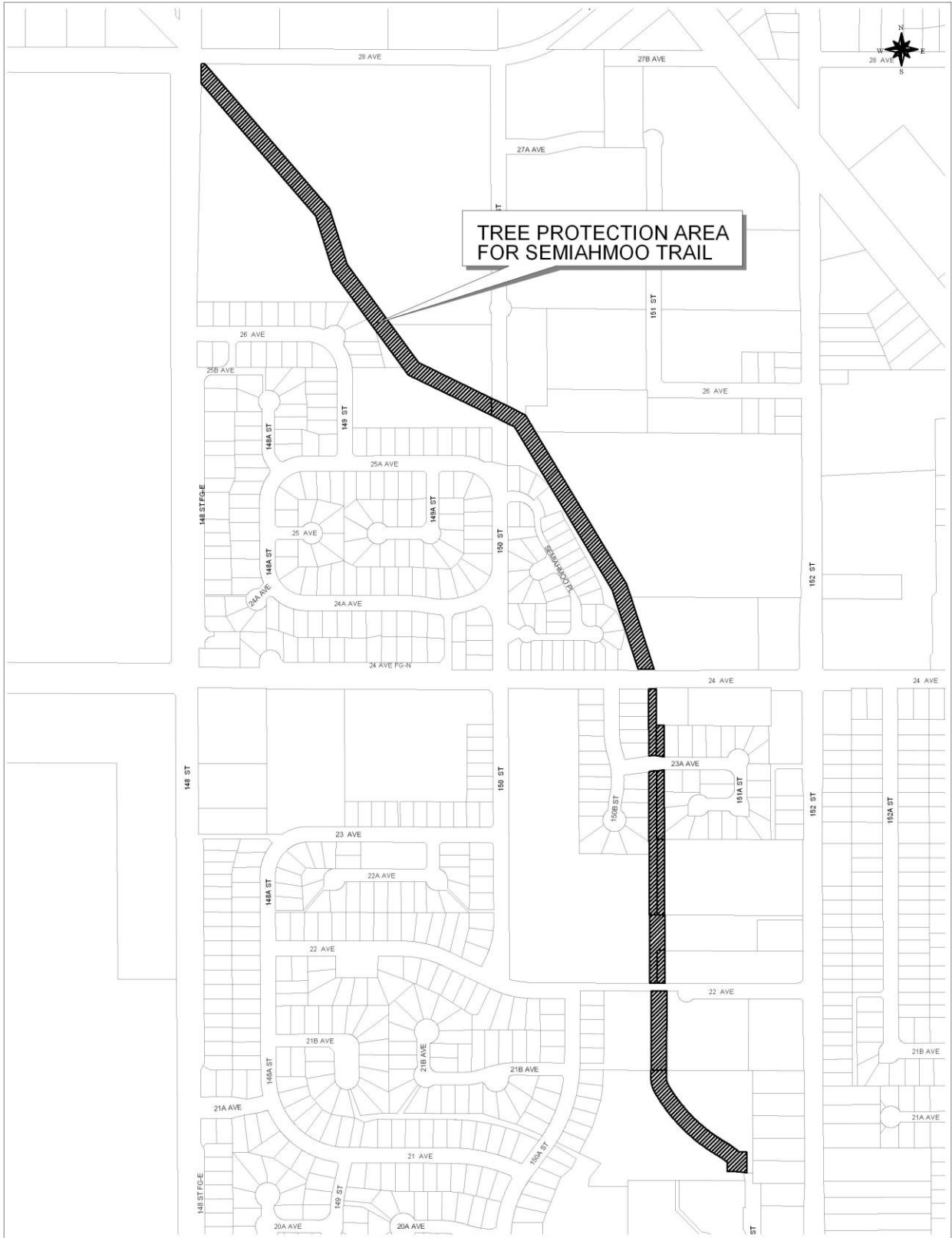

## SCHEDULE "C"

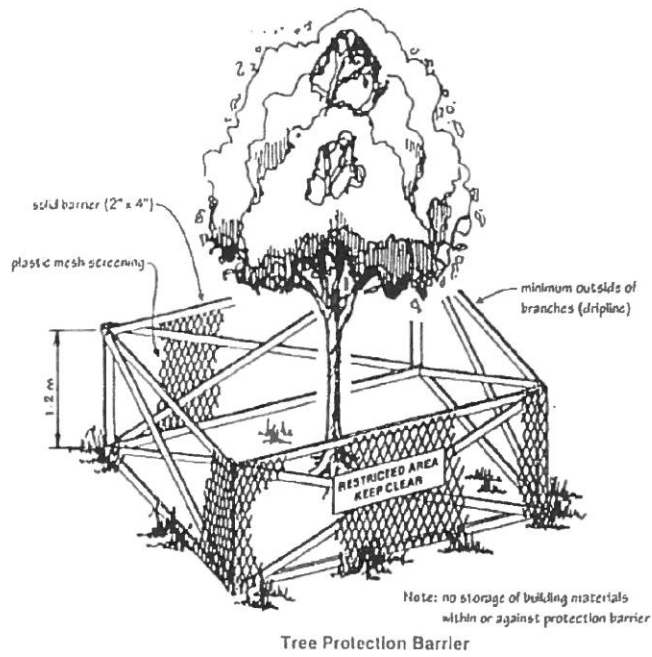

Tree Protection Distance Table

Trunk Diameter (cm)	Minimum Protection Req'd Around Tree (distance from trunk in metres)
20	1.2
25	1.5
30	1.8
35	2.1
40	2.4
45	2.7
50	3
55	3.3
60	3.6
75	4.5
90	5.4
100	6.0

Tree Protection Barrier Detail